

DISASSEMBLY

1. 100 A:

REMOVE GENERATOR COVER (Canada) AND CORD CLIP

- (a) Canada:
Remove the bolt, nut, generator cover.
- (b) Except Canada:
Remove the bolt and cord clip.

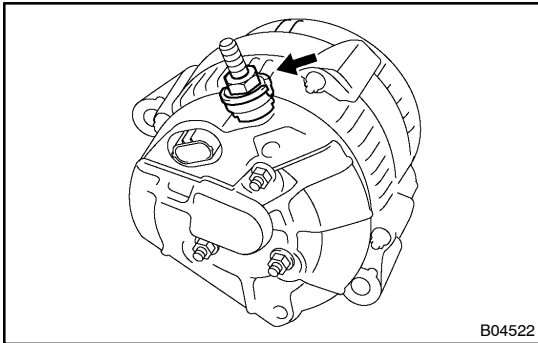

2. REMOVE REAR END COVER

- (a) Remove the nut and terminal insulator.

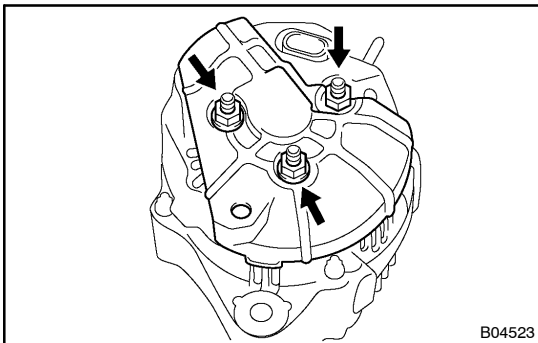

- (b) Remove the 3 nuts and rear end cover.

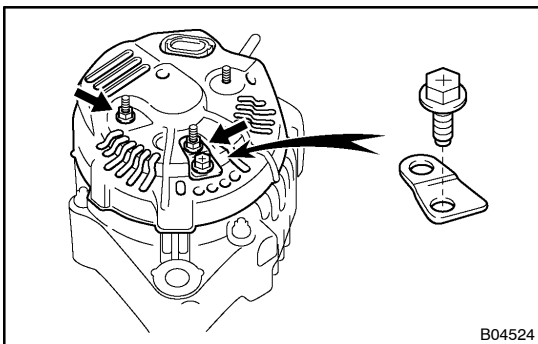

- (c) Remove the 2 nuts, bolt, plate terminal and rear end cover.

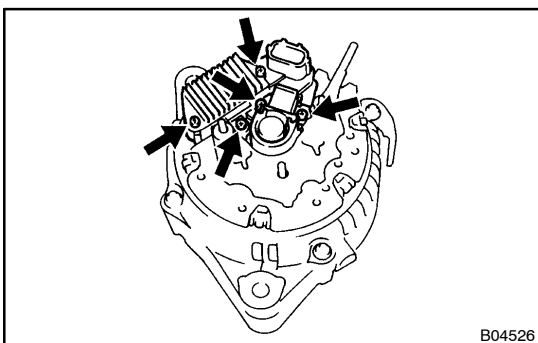

3. REMOVE BRUSH HOLDER AND VOLTAGE REGULATOR

- (a) Remove the brush holder cover from the brush holder.
- (b) Remove the 5 screws, brush holder and voltage regulator.
- (c) Remove the seal plate from the rectifier end frame.

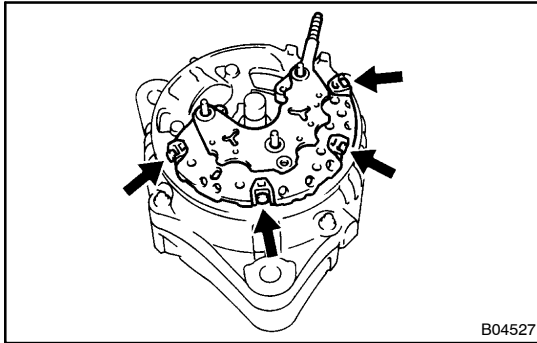

4. REMOVE RECTIFIER HOLDER

- (a) Remove the 4 screws and rectifier holder.
- (b) Remove the 4 rubber insulators.

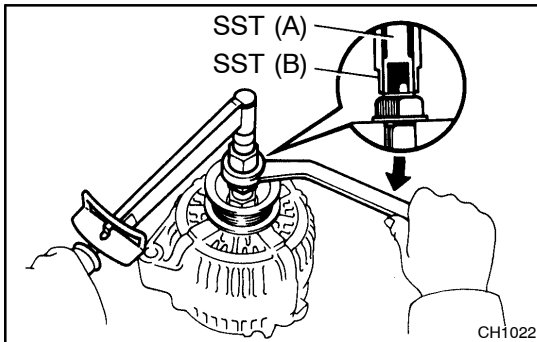

5. REMOVE PULLEY

- (a) Hold SST (A) with a torque wrench, and tighten SST (B) clockwise to the specified torque.
SST 09820-63010
Torque: 39 N·m (400 kgf·cm, 29 ft·lbf)
- (b) Check that SST (A) is secured to the rotor shaft.

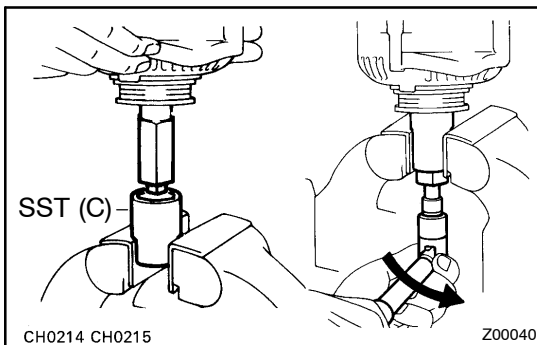

- (c) As shown in the illustration, mount SST (C) in a vise, and install the generator to SST (C).
- (d) To loosen the pulley nut, turn SST (A) in the direction shown in the illustration.

NOTICE:

To prevent damage to the rotor shaft, do not loosen the pulley nut more than one-half of a turn.

- (e) Remove the generator from SST (C).
- (f) Turn SST (B), and remove SST (A and B).
- (g) Remove the pulley nut and pulley.

6. REMOVE RECTIFIER END FRAME

- (a) 80 A:
Remove the 4 nuts and cord clip.
- (b) 100 A:
Remove the 4 nuts.

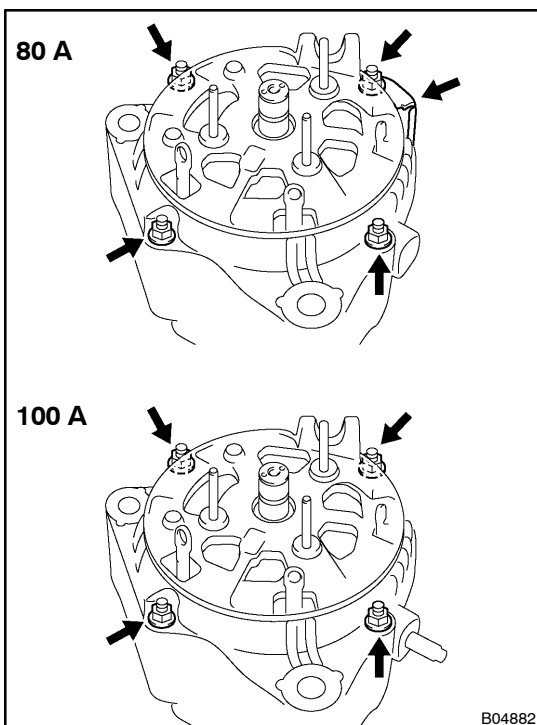

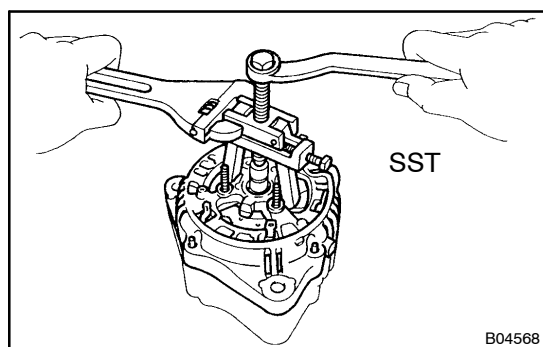

- (c) Using SST, remove the rectifier end frame.
SST 09286-46011
- (d) Remove the generator washer.

7. REMOVE ROTOR FROM DRIVE END FRAME